

Rubber Lined Cable Hook Replacement

READ THESE INSTRUCTIONS COMPLETELY BEFORE YOU START. IF YOU DON'T UNDERSTAND THESE INSTRUCTIONS, PLEASE CALL 800-453-1192 FOR ASSISTANCE

Procedure for replacing the Rubber Lined Cable Hook on Little Giant Ladder Systems **Extension** ladders.

1. Failure to comply with all instructions may result in serious injury.
2. Make sure this kit is compatible with your ladder. If you have any questions concerning the use of this kit on Little Giant Ladder Systems products, call 800-453-1192 for assistance.
3. Before installing this kit, identify all kit components. If any components are missing or damaged, please contact Customer Care. Do not substitute any components.
4. Inspect the ladder before installing this kit. Repair or replace any damaged or missing ladder parts before using the ladder. Use only Little Giant Ladder Systems repair or replacement parts. If you are unable to repair it, discard the ladder.

COMPONENTS IN KIT



Rubber Lined
Cable Hook

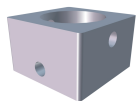

Spring Stop



Roll Pin

TOOLS NEEDED

Hammer



5/32" Punch



NOTE: IF ANY OTHER PART OF THE LADDER IS DAMAGED BEFORE OR DURING THE PROCESS OF INSTALLING AND/OR REPAIRING, DISCARD THE LADDER OR CONTACT CUSTOMER CARE FOR INSTRUCTIONS.

DO NOT USE A DAMAGED LADDER!

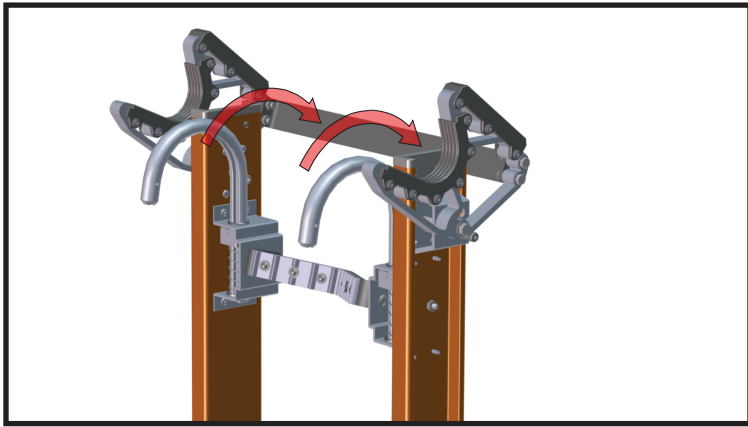

1. Roll the Cable Hook Assembly back (as shown in the illustration) to make the following steps easier.

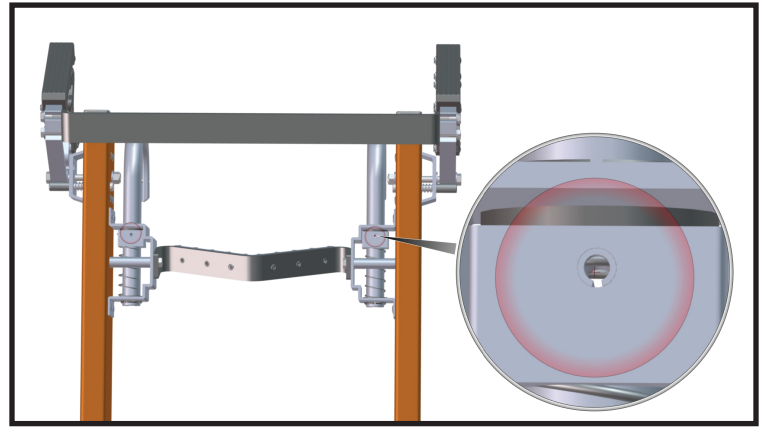

2. Locate the (existing) Roll Pin located inside the Spring Stop.

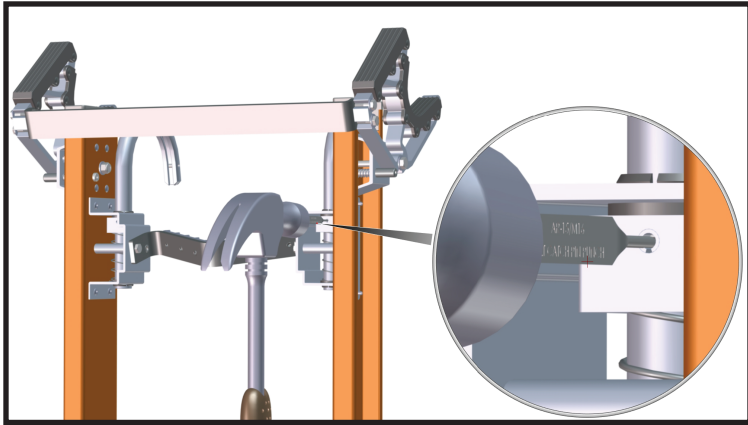

3. Using a hammer and a 5/32" punch, remove the (existing) Roll Pin from the Spring Stop.

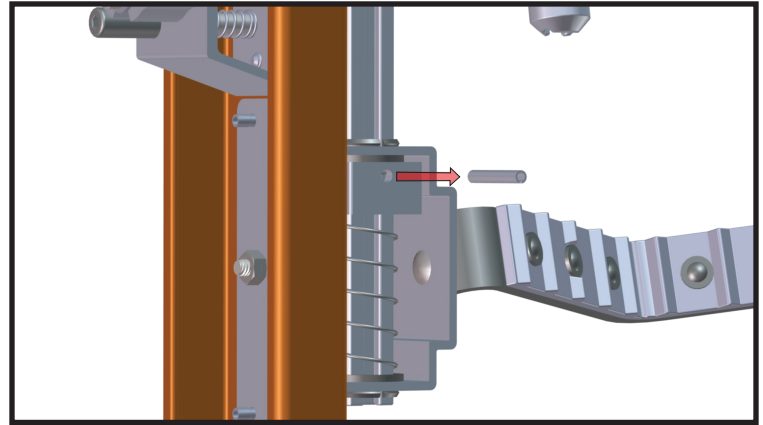

4. Once the (existing) Roll Pin has been removed, discard.

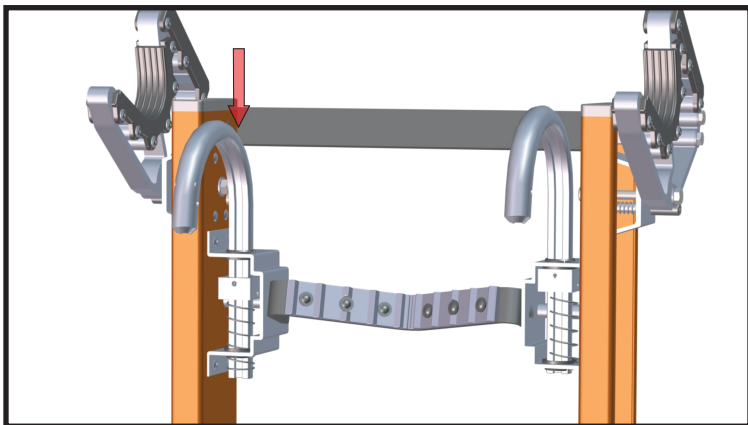

5. Push down on the (existing) Cable hook.

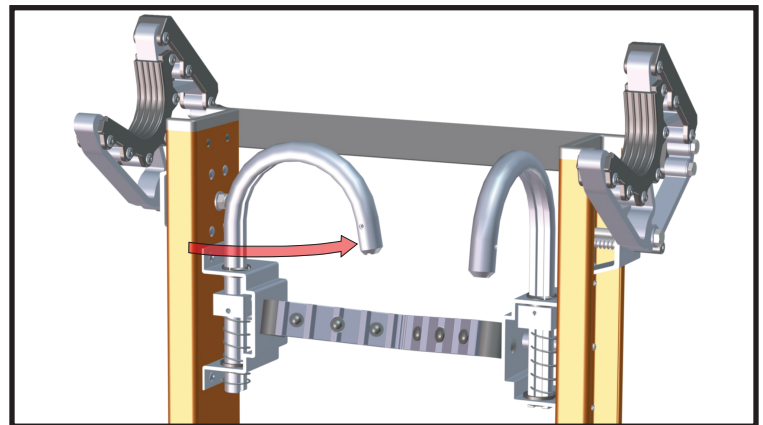

6. Rotate the (existing) Cable Hook inwards.

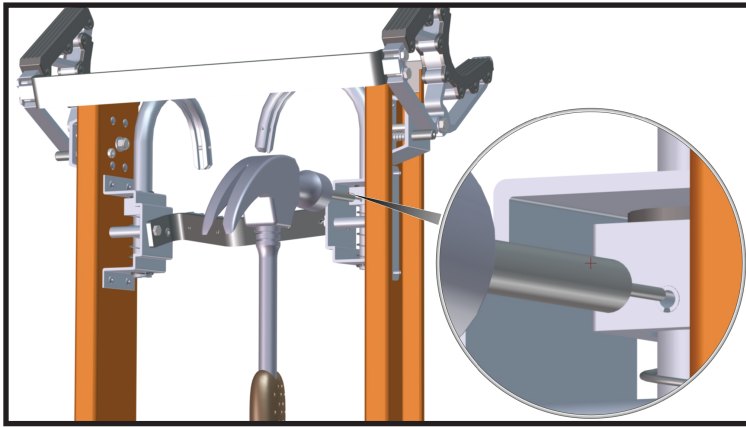

7. When you rotate the (existing) Cable Hook, it will make the second (existing) Roll Pin accessible on the Spring Stop. Using the hammer and the 5/32" punch, remove the (second existing) Roll Pin.

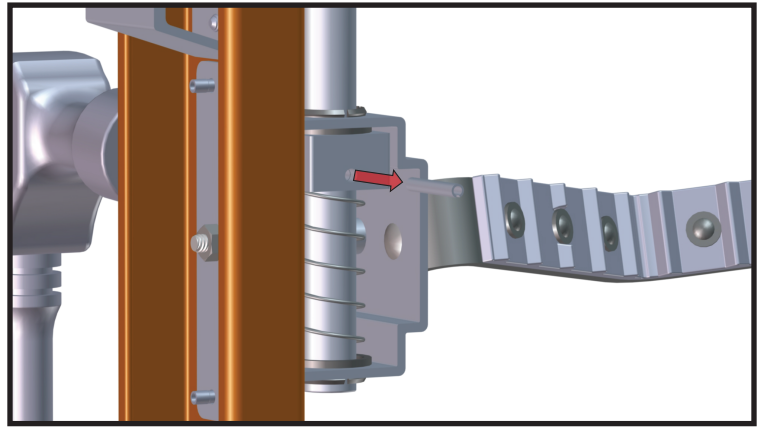

8. Once the (second existing) Roll Pin has been removed, discard.

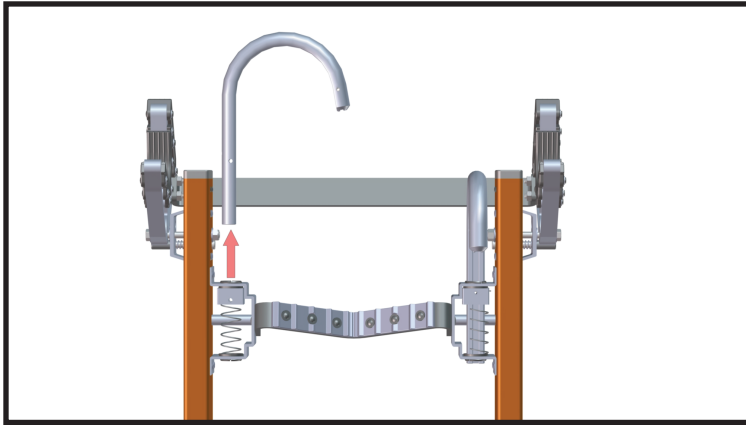

9. Remove and discard the (existing) Cable Hook.

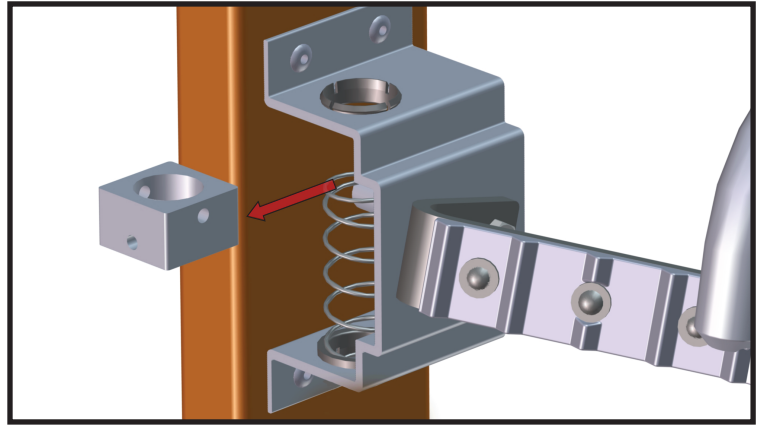

10. Push down on the (existing) spring and remove and discard the (existing) Spring Stop.

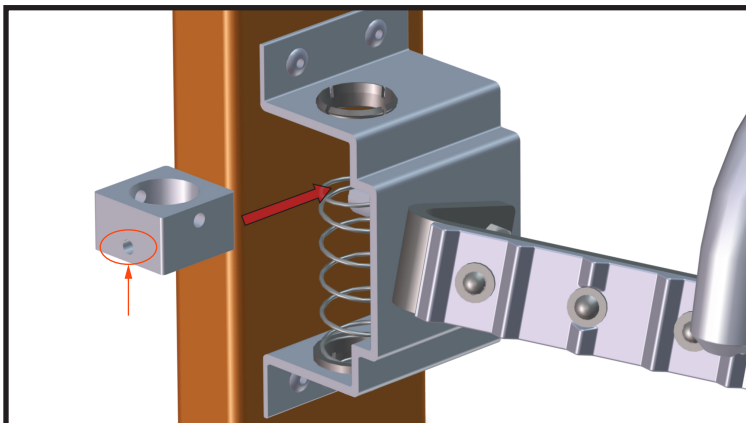

11. Push down on the (existing) spring and insert the (new) Spring Stop. ****Take special care**, that when you insert the (new) Spring Stop that the lower hole is facing outwards (as shown in the illustration).

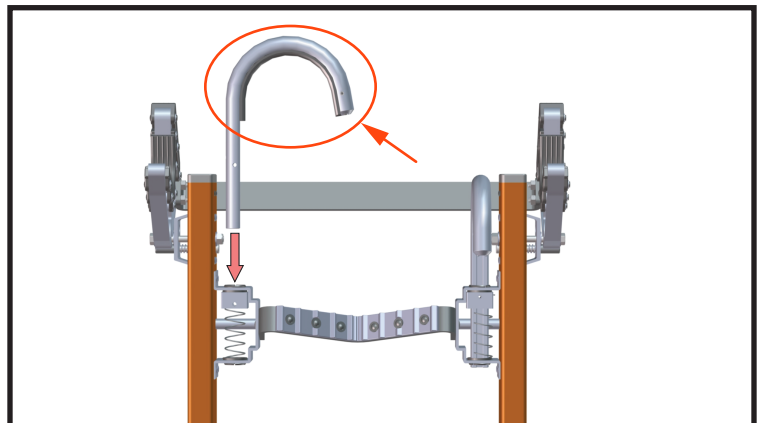

12. Insert the (new) Rubber Lined Cable Hook into the cable hook bracket and through the (new) Spring Stop and (existing) spring.

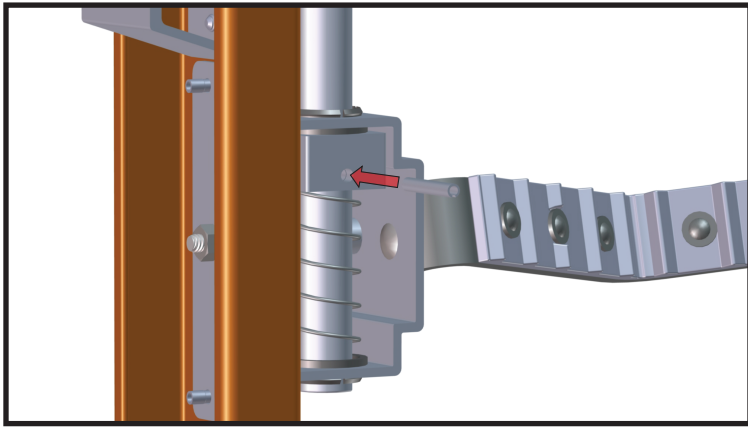

13. Insert the (new) Roll Pin into the (new) Spring Stop. If needed, tap it into place with a hammer.

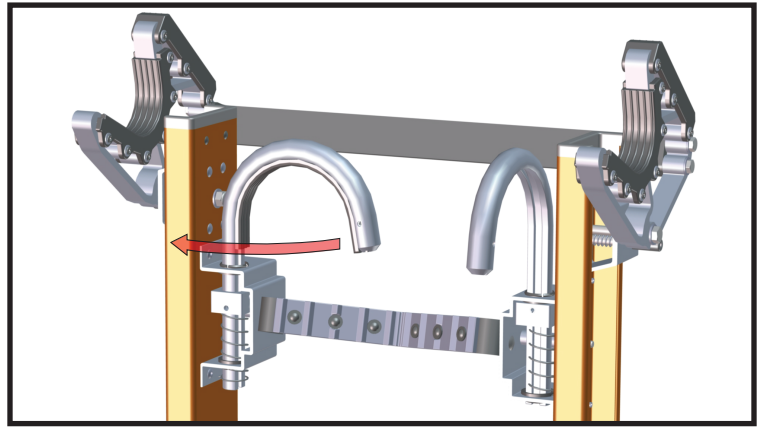

14. Rotate the (new) Rubber Lined Cable Hook, as shown in the illustration.

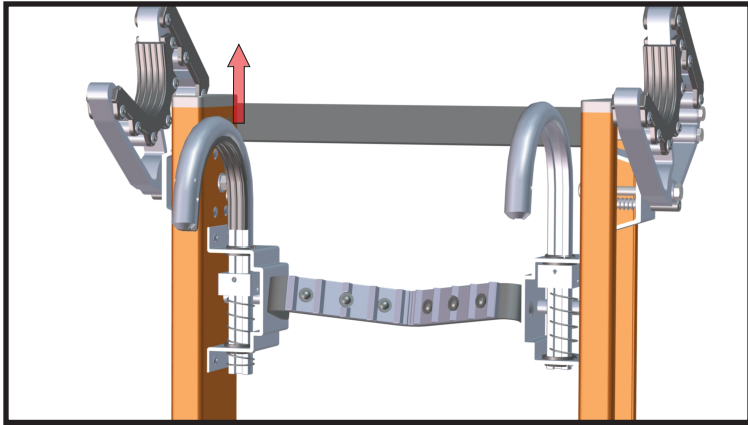

15. When you rotate the (new) Rubber Lined Cable Hook it will snap up and into place.

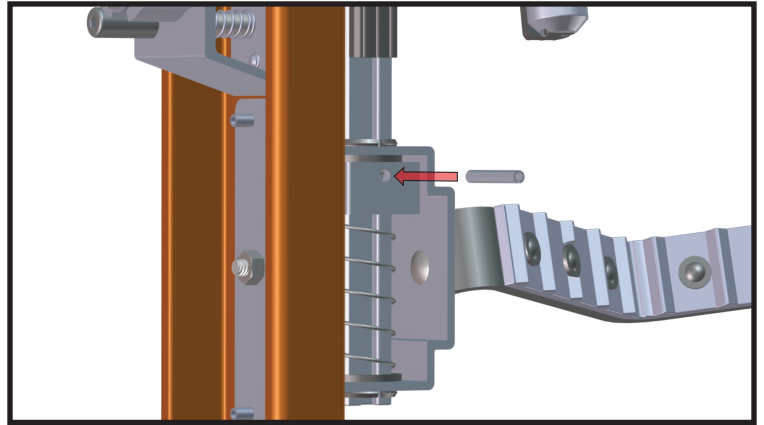

16. Insert the (second new) Roll Pin into the (new) Spring Stop. If needed, tap it into place with a hammer.

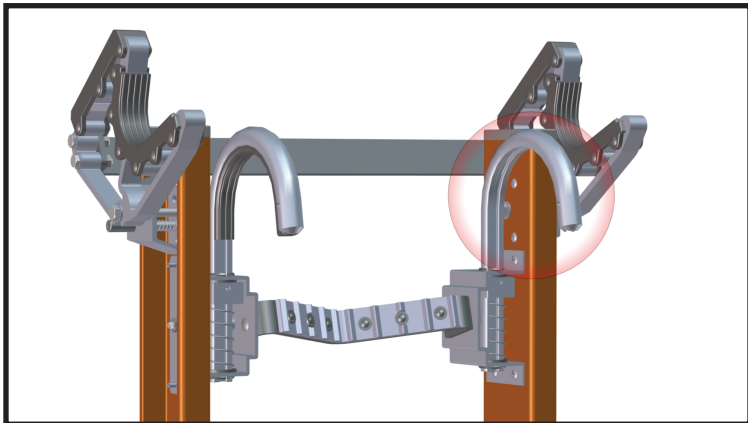

17. Repeat steps 2-16 on the opposite Cable Hook.